

# FENDER FLARE INSTALLATION INSTRUCTION

NISSAN TITAN 04-15 ( with Storage Door)

## Item No. 802-0711 (Pocket-n-Bolt Style)

### Make & Modle

- Qty (1) Fender Flare Left Front (LF)
- Qty (1) Fender Flare Left Rear (LR)
- Qty (1) Fender Flare Right Front (RF)
- Qty (1) Fender Flare Right Rear (RR)
- Qty (1) Rubber Seal(enough for four flares's outer edge)

### 1. Pre-Installation

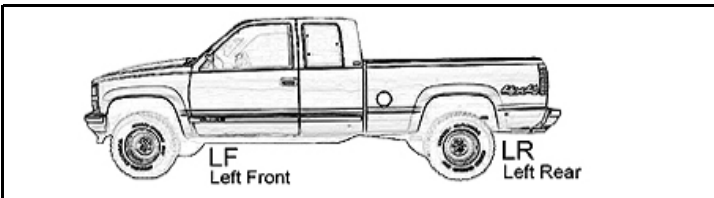

1. Prefit and ensure both left (driver) side & right (passenger) side fender flare to the vehicle before painting or installation.
2. You may remove any moldings, strips or existing flares from the vehicle for fitting or installation.

### 3. Clean Vehicle Body & Fender Flare

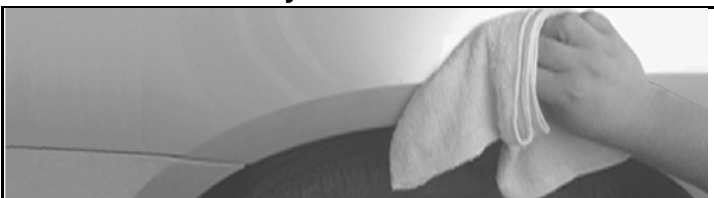

1. Wash and wipe dry the areas of contact on the vehicle body.
2. Clean the surface and inside edge of the fender flare where the rubber seal is to be attached.

### 5. Installation for All Style (Left Front Flare Shown)

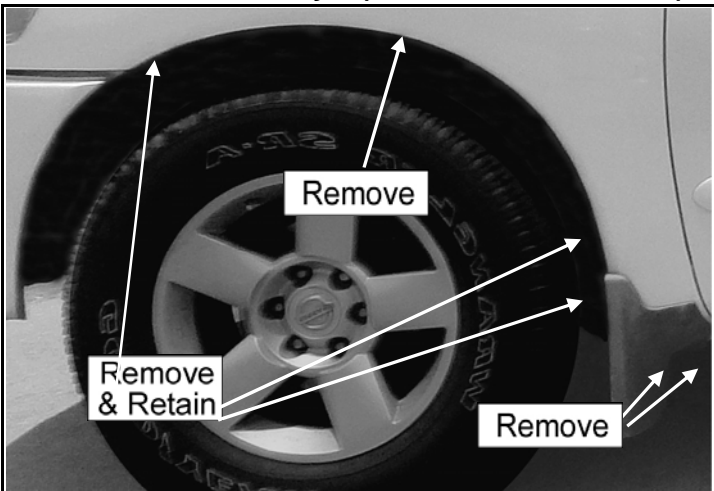

1. **With Mud Flap**- Remove existing screws & 1 extra screw above, save screws for reinstallation. **(see illustration)**
2. **Without Mud Flap**- Remove 2 factory screws on the side,
3. Remove 1 factory screw located at most front of fender, just above the bumper, save screw for reinstallation.
4. Remove 1 factory screw located at most top of fender,

Qty (1) Truss Screw

Qty (15) S-Clip & Machine Screw

Qty (2) Fastener w/ Spacer 5mm

Qty (1) 13 mm Spacer

Qty (36) Allen Bolt, Nut & Washer (Hex Key required)

Qty (8) Self Tapping Screw(see **optional B**)

### 2. Paint Flare(Optional)

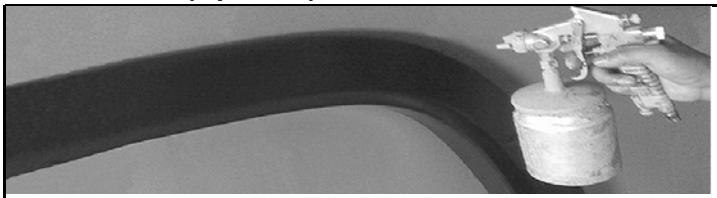

1. Hire a professional painter or body shop and follow the paint manufacturer specifiactions to paint the flares.
2. Clean all fender flares surfaces with clean water and a mild detergent before paint, do not use lacquer thinner or any solvent based products.

### 4. Apply Rubber Seal

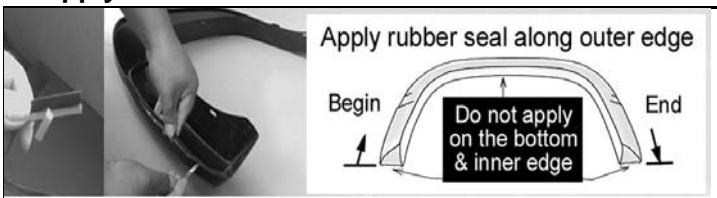

1. Remove about 1 inch tape liner from rubber seal and apply it on the flare, start one end and along the edge that comes in contact with body panel, apply pressure on the tape to ensure that it adheres well, trim excess rubber seal and so on.

### 6. Installation for All Style (Left Front Flare Shown)

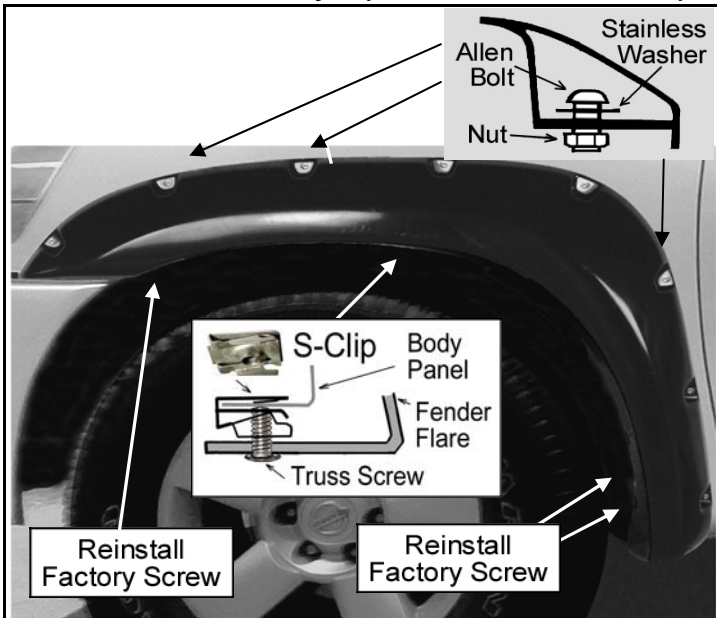

1. Use hex key to tight allen bolt & nylon nut firmly on every pocket of the fender flares. **DO NOT OVER TIGHTEN !**
2. Apply 2 S-Clip over 2 location and secure it with 2 machine screws.(Do not fully tighten screws)(**see right illustration**)
3. Line up the 3 holes in flare with factory holes and hold the flare firmly, reinstall 3 factory screws into the holes that were previously removed. **(see right illustration)**
4. Tighten the screws on S-Clip.

**Optional B:** The included self tapping screw may be used for extra secure if needed.

All rights reserved by original. No part of this publication may be reproduced.

### 7. Installation for All Style (Right Rear Flare Shown)

### 8. Installation for All Style (Right Rear Flare Shown)

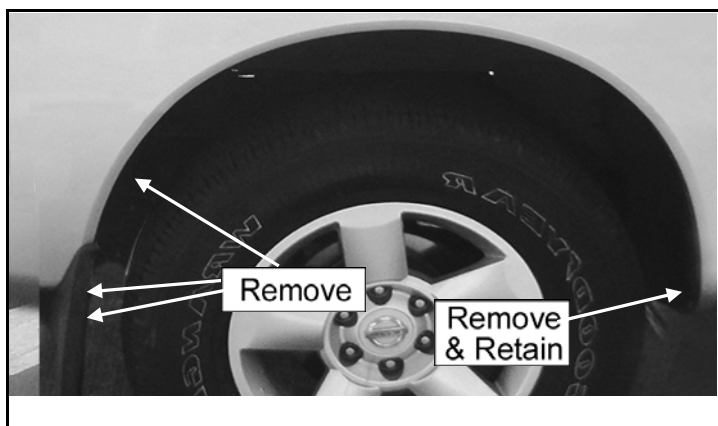

1. **With Mud Flap-** Remove existing screws & 1 extra screw above. (see illustration)
2. Remove 1 factory screw located at most front of fender, save screw for reinstallation. (see illustration)

### 9. Installation for All Style (Left Rear Flare Shown)



1. **With Mud Flap-** Remove existing screws & 1 extra screw above. (see illustration)

### 11. Installation for All Style (Left Rear Flare Shown)

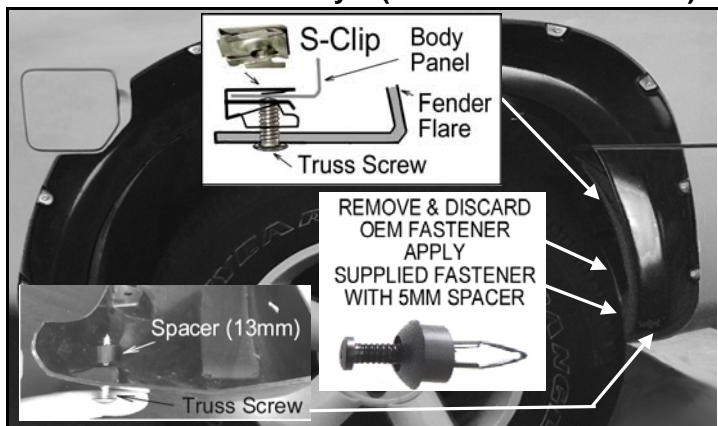

#### Without Mud Flap

1. Pry out the factory fastener on the bottom of the door and discard
2. Open the access door and remove the edge protector from the door lip and discard.
3. Install supplied truss screw through spacer(13mm) into factory hole on the bottom of the fender, **as lower right shown.** (Do not fully tighten screw)
4. Apply 1 S-Clip over the location and secure it with machine screw, **as top shown.** (Do not fully tighten screw)
5. Apply 2 supplied fastener with 5mm spacer(on outside of flare) into factory holes, **as center shown.**
6. Line up the flare properly and hold the flare firmly, tighten all screws.

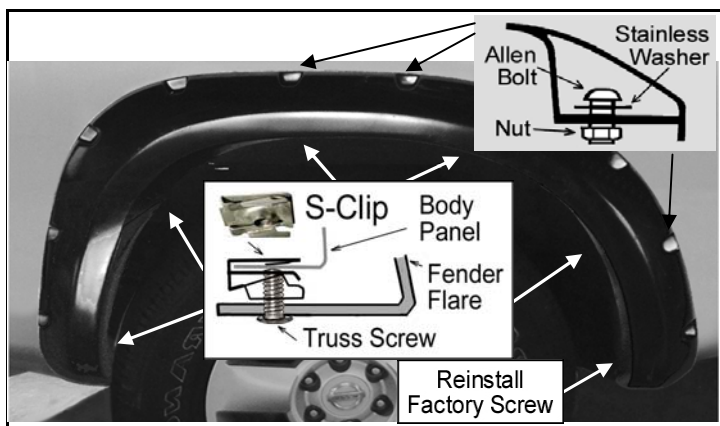

1. Use hex key to tight allen bolt & nylon nut firmly on every pocket of the fender flares. **DO NOT OVER TIGHTEN !**
2. Apply 5 S-Clip over 5 location and secure it with 5 machine screws. (Do not fully tighten screws) (see right illustration)
3. Line up the hole in flare with factory hole and hold the flare firmly, reinstall factory screw into the hole that were previously removed.
4. Tighten the screws on S-Clip.

### 10. Installation for All Style (Left Rear Flare Shown)

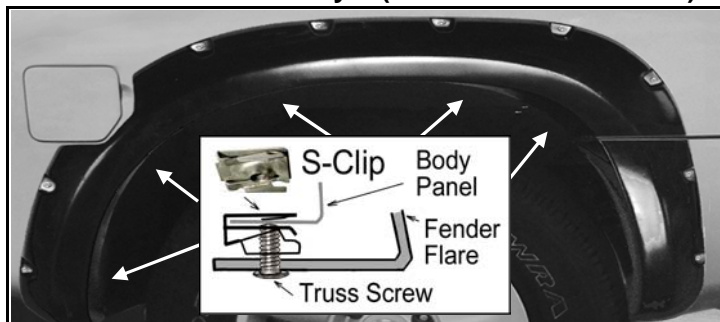

1. Apply 5 S-Clip over 5 location and secure it with 5 machine screws. as **illustration.** (Do not fully tighten screws)
2. Line up the flare properly and hold the flare firmly, tighten all screws, start from right side toward the access door.

### 12. Installation for All Style (Left Rear Flare Shown)

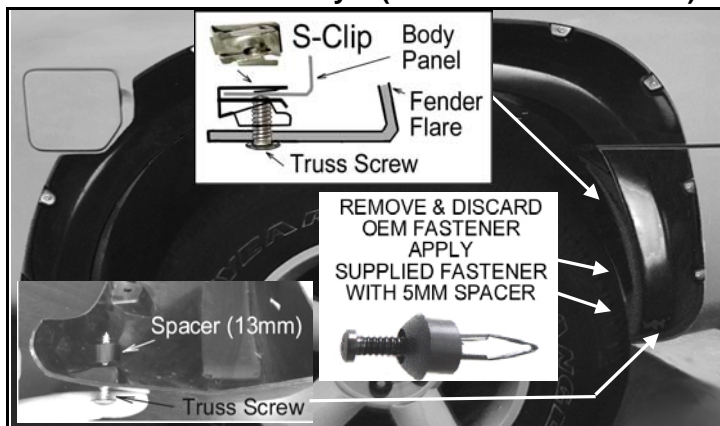

#### Without Mud Flap

1. Remove factory mud flap and save the hardware.
2. Pry out the factory fastener on the bottom of the door and discard
3. Open the access door and remove the edge protector from the door lip and discard.
4. Install supplied truss screw through spacer(13mm) into factory hole on the bottom of the fender, **as lower right shown.** (Do not fully tighten screw)
5. Apply 1 S-Clip over the location and secure it with machine screw, **as top shown.** (Do not fully tighten screw)
6. Apply 2 supplied fastener with 5mm spacer(on outside of flare) into factory holes, **as center shown.**
7. Line up the flare properly, hold the flare firmly, tighten all screws.