

FENDER FLARE INSTALLATION INSTRUCTION

DODGE RAM 02-05,06-09 FULL SIZE ONLY

Item No. 1ABFK00012 (Rugged Style)

Parts

- Qty (1) Fender Flare Left Front (LF)
- Qty (1) Fender Flare Left Rear (LR)
- Qty (1) Fender Flare Right Front (RF)
- Qty (1) Fender Flare Right Rear (RR)

Pre-Installation

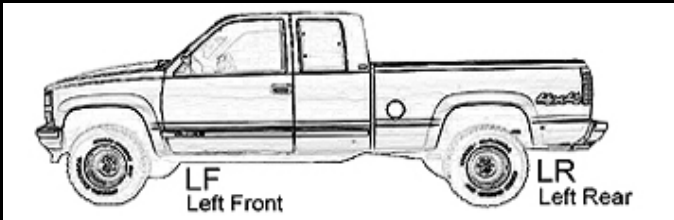

Prefit and ensure both left(driver side) and right(passenger side) hand fender flare to the vehicle before painting or installation. You may remove any moldings, strips or existing flares from the vehicle for fitting and installation.

Cleaning

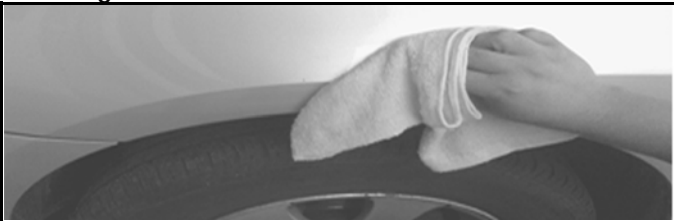

Wash and wipe dry the areas of contact on the vehicle body. Clean the surface and inside edge of the fender flare where the rubber seal is to be attached.

Installation (Left Front Flare Shown)

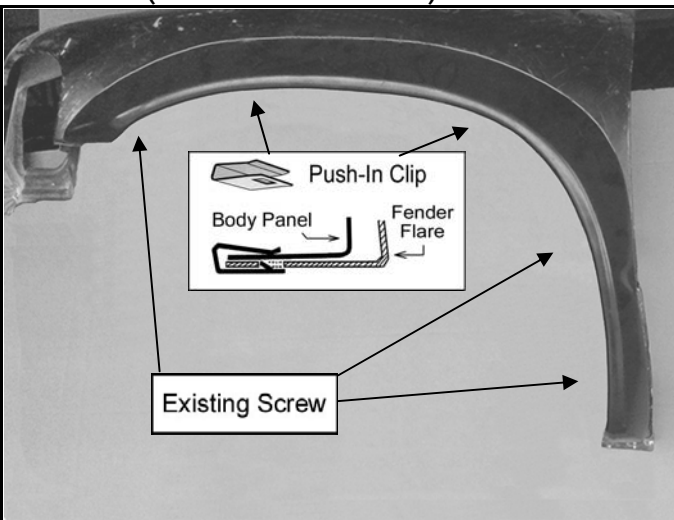

Place the flare on the vehicle with best position. Apply 2 Push-In Clip into the mounting slot in flare and secure it to the vehicle as shown. Fasten the existing factory screws into the original location that were previously removed.

Optional B: The included self tapping screw may be used for extra secure if needed.

All rights reserved by original. No part of this publication may be reproduced.

- Qty (1) Rubber Seal(enough for four flares's outer edge)
- Qty (10) Push-In Clip
- Qty (4) U-Clip with Screw
- Qty (8) Self Tapping Screw (see **optional B**)

Painting(optional A)

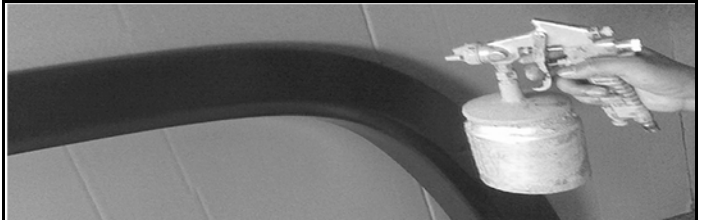

Hire a professional painter or body shop and follow the paint manufacturer specifications to paint the flares. Clean all fender flares surfaces with clean water and a mild detergent before paint, do not use lacquer thinner or any solvent based products.

Apply Rubber Seal

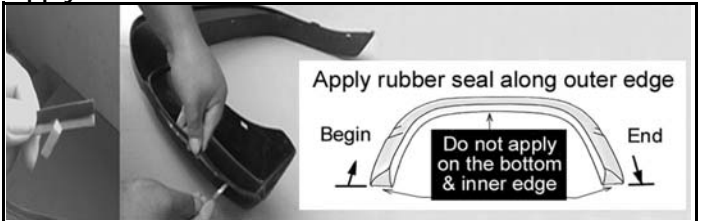

Remove 1 inch tape liner from rubber seal, apply it on the flare, start one end & along the edge that comes in contact with body panel. **Caution: 3M tape will stick on the inside of the flare.** Make sure the rubber seal along the edge well, and rip the tape liner off gradually, apply pressure on the tape in the same time to ensure that it adheres well. Trim excess rubber seal and so on.

Installation (Left Rear Flare Shown)

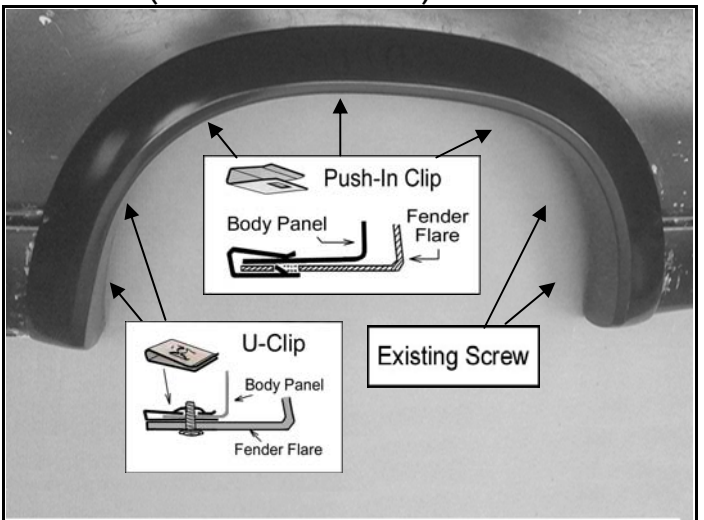

Place the flare on the vehicle with best position. Apply 3 Push-In Clip into In Clip into the mounting slot in flare and secure it to the vehicle 4 U-Clips secure into the hole with screw, as shown. Fasten the existing factory screws into the original location that were previously removed.