

FENDER FLARE INSTALLATION INSTRUCTION

DODGE RAM 1994-2001 FULL SIZE

Item No. 1ABFK00027 (Pocket Style)

Parts

Qty (1) Fender Flare Left Front (LF)
Qty (1) Fender Flare Left Rear (LR)
Qty (1) Fender Flare Right Front (RF)
Qty (1) Fender Flare Right Rear (RR)
Qty (1) Rubber Seal(enough for four flares's outer edge)

Qty (4) U-Clamp with Flat Head Screw
Qty (14) J-Clip
Qty (36) Allen Bolt, Nut & Washer (Torx Bit required)
Qty (8) Self Tapping Screw(see **optional B**)

Pre-Installation

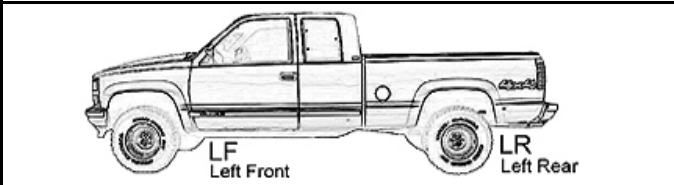

Prefit and ensure both left(driver side) and right(passenger side) hand fender flare to the vehicle before painting or installation. You may remove any moldings, strips or existing flares from the vehicle for fitting or installation.

Cleaning

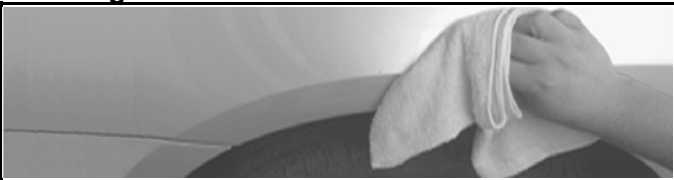

Wash and wipe dry the areas of contact on the vehicle body. Clean the surface and inside edge of the fender flare where the rubber seal is to be attached.

Installation (Left Front Flare Shown)

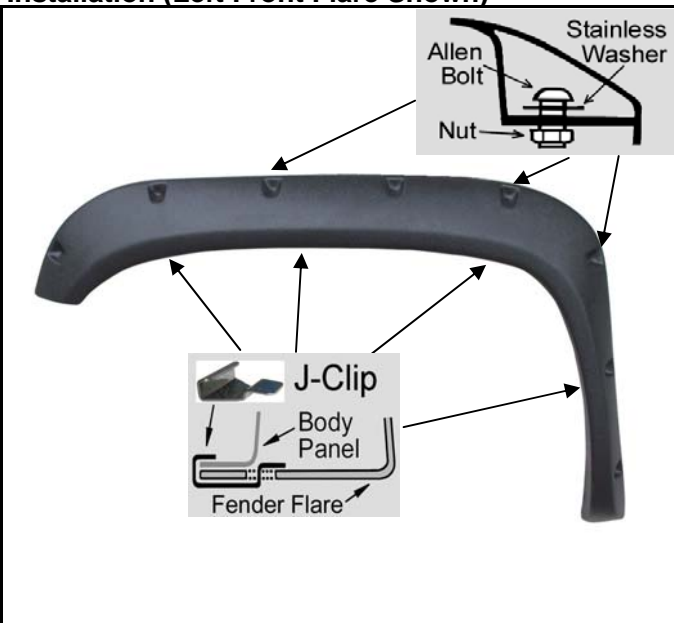

Use Torx Bit to tight allen bolt & nut firmly on every pocket of the fender flares first, then place the flare on the vehicle with best position. Apply 4 J-Clips into the mounting slot in flare and secure it to the vehicle, as shown.

Painting(optional A)

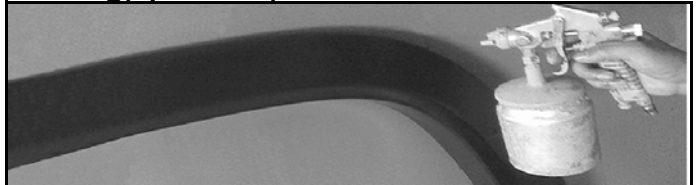

Hire a professional painter or body shop and follow the paint manufacturer specifications to paint the flares. Clean all fender flares surfaces with clean water and a mild detergent before paint, do not use lacquer thinner or any solvent based products.

Apply Rubber Seal

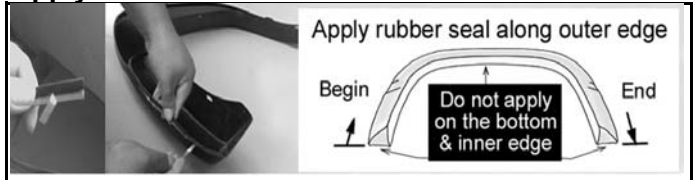

Remove about 1 inch tape liner from rubber seal and apply it on the flare, start one end and along the edge that comes in contact with body panel, apply pressure on the tape to ensure that it adheres well, trim excess rubber seal and so on.

Installation (Left Rear Flare Shown)

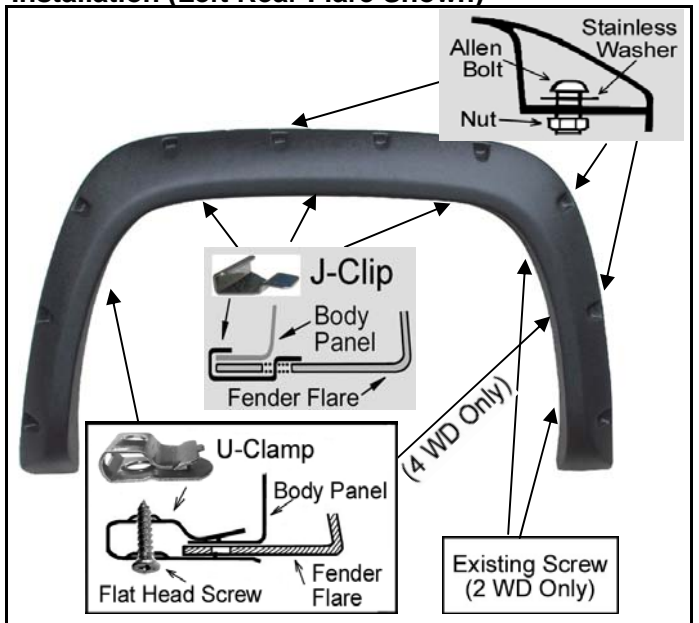

Use Torx Bit to tight allen bolt & nut firmly on every pocket of the fender flares first, then place the flare on the vehicle with best position. Apply 3 J-Clips into the mounting slot in flare and secure it to the vehicle, 2 U-Clamps secure into the hole with flat head screw, as shown. Fasten the existing factory screws into the original location that were previously removed for 2 WD.

Optional B : The included self tapping screw may be used for extra secure if needed.

All rights reserved by original. No part of this publication may be reproduced.